

INVACARE®
G-SERIES
BED

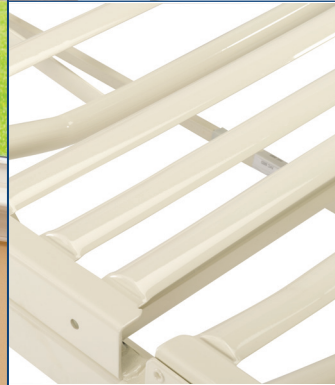

The Invacare® G-Series Bed is certified to the IEC 60601-2-52 standard for safety and essential performance of medical beds. With Invacare's G-Series Bed you will have the peace of mind that your bed frame, mattress and rails have passed stringent tests to help ensure the highest standard for patient safety in the homecare environment. Invacare's G-Series Bed is designed to deliver new and innovative features that further meet patients' needs.

Invacare beds, mattresses and rails, excluding therapeutic support surfaces and bariatric beds, when used as a system and sold new and unused after August 1, 2007, meet the FDA guidance document on "Hospital Bed System Dimensional and Assessment Guidance to Reduce Entrapment." Visit www.invacare.com/bedsafety for additional safety and entrapment information.

Features

Newly Designed Hand Pendant - The pendant is ergonomically designed and fluid proof, with an extended heavy duty strain relief for increased flexibility. Connects on either side of the bed for patient's ease of use.

Supportive Sleep Surface - The slat deck is designed to provide a comfortable sleep surface for patients, reduces wear and tear on the mattress and is simple to clean, allowing for improved infection control.

Interchangeable Bed Ends - Extra extensive travel range. Easy to clean and impact-resistant.

Secure Mattress Keepers - Securely position the mattress to prevent sliding.

Ergonomic Bed Sections - Ergonomically designed head and foot sections with elongated head section for increased patient comfort.

IP66 Rating - Water-resistant connections designed to prevent fluid ingress.

Crank Through Electronics - Designed to allow all motors to be operated manually in the event of a power outage.

HCPCS Code: E0265

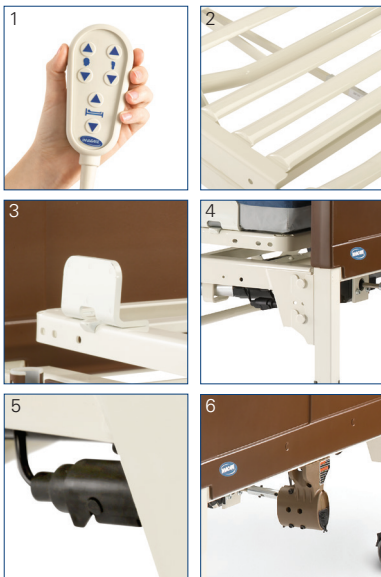

1. Newly designed hand pendant
2. Supportive sleep surface
3. Secure mattress keepers
4. Advanced electronic features
5. IP66 rating
6. Crank through electronics



Invacare Corporation
www.invacare.com

USA
One Invacare Way
Elyria, Ohio
44035-4190
(800) 333-6900

Canada
570 Matheson Blvd. E.,
Unit 8
Mississauga, Ontario
L4Z 4G4 Canada
(800) 668-5324

©2020 Invacare Corporation. All rights reserved. Trademarks are identified by the symbols ™ and ®. All trademarks are owned by or licensed to Invacare Corporation unless otherwise noted. Specifications are subject to change without notification. Form No. 14-285 Rev. 09/20 200610

Model #	Dimensions	Sleep Surface	Weight Capacity	Shipping Weight	Carton Dimensions	Regulation Compliance	Limited Warranty
G5510	36" W 88" L 15"-32" (travel range)	36" W 80" L	Safe Working Load: 450 lb.* Max. Patient Weight: 350 lb.	N/A	N/A	IEC 60601-2-52 IEC 60601-1-11 IP66 ANSI/AAMI 60601-1 3rd Ed.	2 Years Mechanical and Electrical 5 Years Welds
G50 Headspring	36"W x 45"L x 8"H			47 lb.	47" x 8" x 36"		2 Years Mechanical and Electrical 5 Years Welds
G54 Footspring	36"W x 37.5"L x 8"H			57 lb.	47" x 9" x 37"		2 Years Mechanical and Electrical 5 Years Welds
G53 Bed Ends	39"W x 7"L x 33"H			54 lb.	39" x 7" x 34"		2 Years Mechanical and Electrical 5 Years Welds

*Includes patient, mattress and all accessories.

All references to HCPCS codes: Providers are responsible for determining the appropriate billing codes when submitting claims to the Medicare program, and should consult an attorney or other advisor to discuss specific situations in further detail.

